

CITY CEMETARY

HELPER UTAH

MT. VIEW CEMETARY

Location in NE 1/4 NW 1/4, SEC. 19, TWP. 13 S, R. 10 E.
S.L.B.M.

OWNER'S DEDICATION

Helper City herein dedicates and files this map as the official past and present cemetery layout plan, and has on record ownership files in accordance with this plan, and in more recent years the names of the deceased people buried. This is done by authority of the Helper City Council

Chris P. Jouffles
Chris P Jouffles
Mayor of Helper City

Scale: 1" = 20'
February 1971

Note: Cemetery officially established April 1912.

Dead recorded Book 5B, Page 232; correction Deed Book 5N, Page 271, all in the office of the Carbon County Recorder Price, Utah.

Map compiled from old notes, maps, burial records etc., by John Bene, C.E. Utah 1050., City Engineer, Helper City. Burial records and ownership records on file at the office of the Helper City Recorder Helper, Utah.

Attested by _____

Helper City Recorder

Gate. N 50° 20' E 450' Fence

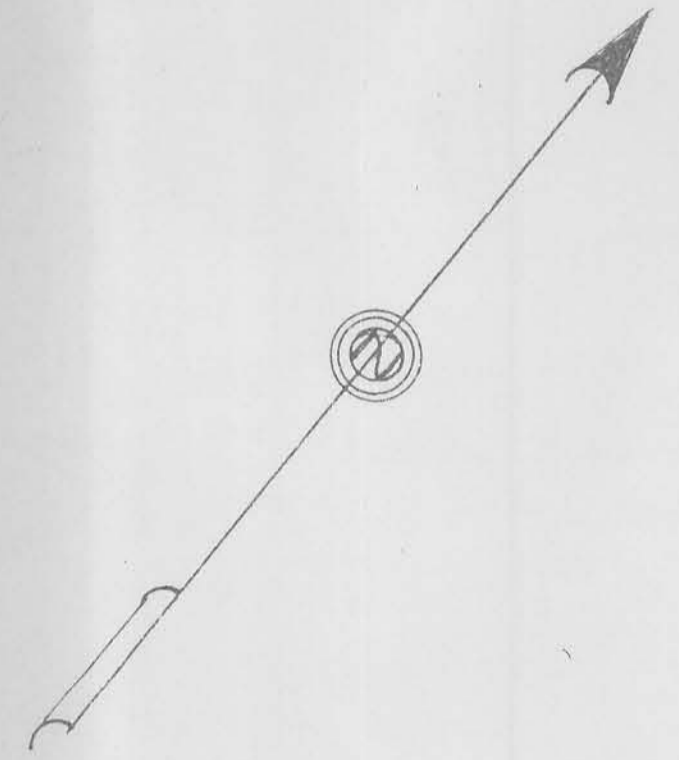

SECTION 2.

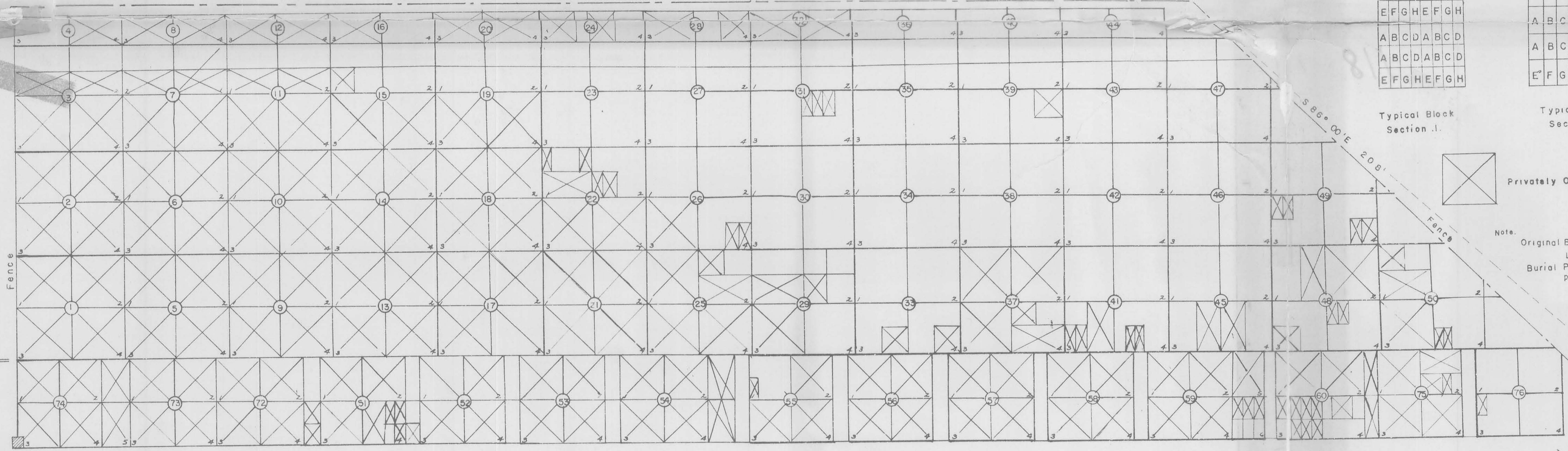

Typical Block Section 1.

E	F	G	H	E	F	G	H
A	B	C	D	A	B	C	D
A	B	C	D	A	B	C	D
E	F	G	H	E	F	G	H

Typical Block Section 2.

E	F	G	H	E	F	G	H
A	B	C	D	A	B	C	D
A	B	C	D	A	B	C	D
E	F	G	H	E	F	G	H

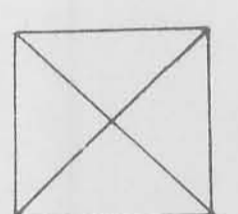

Privately Owned.

Note: Original Block 40' X 40'
Lots 20' X 20'
Burial Plots 8 / lot
Plot 5' X 10'

SECTION 1.

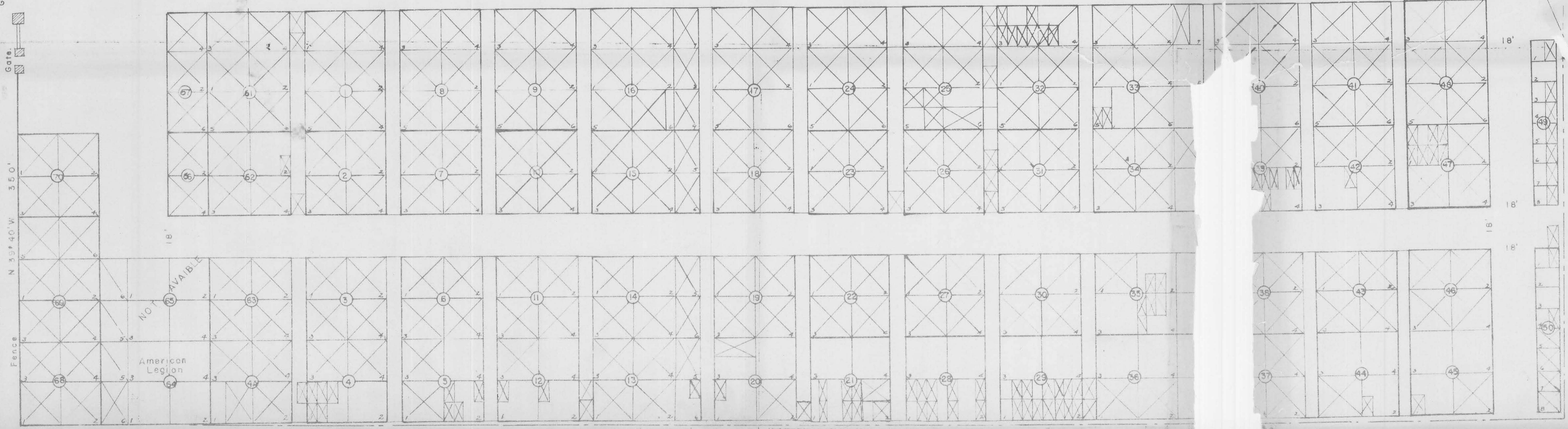

267:24 W. NE. Cor.
214.10 S. Sec. 19, Twp 13 S, R. 10 E
S.L.B.M.

SECTION 1.